

Tiger Mono-facial 440-460 Watt

Tiling Ribbon (TR) Technology

Positive power tolerance of 0~+3%



KEY FEATURES



TR technology + Half Cell

TR technology with Half cell aims to eliminate the cell gap to increase module efficiency (mono-facial up to 20.78%)



9BB instead of 5BB

9BB technology decreases the distance between bus bars and finger grid line which is benefit to power increase.



Higher lifetime Power Yield

2.5% first year degradation,
0.6% linear degradation



Best Warranty

12 year product warranty,
25 year linear power warranty



Reduce Hot-spot issues

TR technology reduced the cell current in both bus bars and finger grid line to reduce hot-spot issues



Avoid debris, cracks and broken gate risk effectively

9BB technology using circular ribbon that could avoid debris, cracks and broken gate risk effectively



- ISO9001:2015, ISO14001:2015, OHSAS18001 certified factory
- IEC61215, IEC61730 certified product

LINEAR PERFORMANCE WARRANTY

12 Year Product Warranty • 25 Year Linear Power Warranty
0.6% Annual Degradation Over 25 years

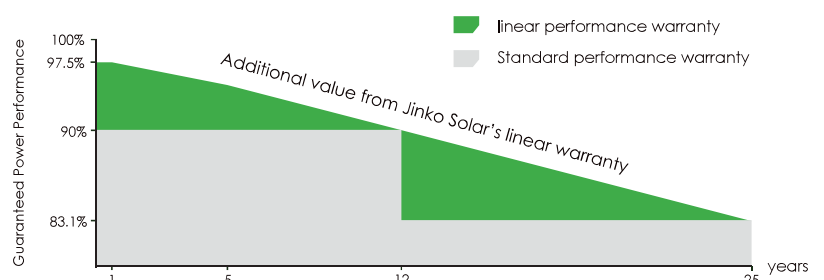

Engineering Drawings

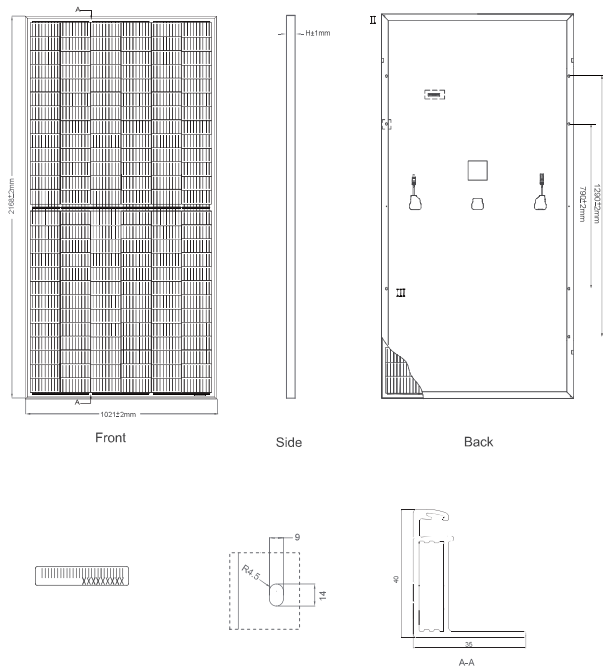

Packaging Configuration

(Two pallets = One stack)

27pcs/pallets, 54pcs/stack, 540pcs/ 40'HQ Container

Electrical Performance & Temperature Dependence

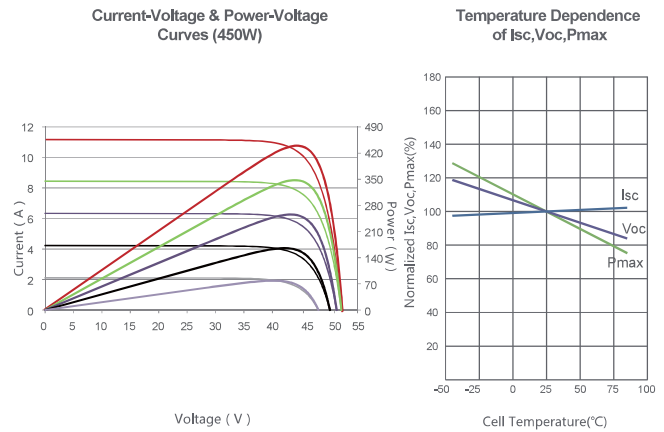

Mechanical Characteristics

Cell Type	P type Mono-crystalline
No.of cells	156 (2×78)
Dimensions	2168×1021×40mm (85.35×40.20×1.57 inch)
Weight	25.4 kg (56.0 lbs)
Front Glass	3.2mm, Anti-Reflection Coating, High Transmission, Low Iron, Tempered Glass
Frame	Anodized Aluminium Alloy
Junction Box	IP67 Rated
Output Cables	TUV 1×4.0mm ² (+): 290mm, (-): 145 mm or Customized Length

SPECIFICATIONS

Module Type	JKM440M-7RL3-V		JKM445M-7RL3-V		JKM450M-7RL3-V		JKM455M-7RL3-V		JKM460M-7RL3-V	
	STC	NOCT	STC	NOCT	STC	NOCT	STC	NOCT	STC	NOCT
Maximum Power (Pmax)	440Wp	327Wp	445Wp	331Wp	450Wp	335Wp	455Wp	339Wp	460Wp	342Wp
Maximum Power Voltage (Vmp)	42.81V	39.44V	42.92V	39.46V	43.02V	39.57V	43.13V	39.69V	43.24V	39.75V
Maximum Power Current (Imp)	10.28A	8.30A	10.37A	8.39A	10.46A	8.46A	10.55A	8.53A	10.64A	8.61A
Open-circuit Voltage (Voc)	51.50V	48.51V	51.60V	48.60V	51.70V	48.70V	51.80V	48.79V	51.90V	48.88V
Short-circuit Current (Isc)	11.14A	9.00A	11.23A	9.07A	11.32A	9.14A	11.41A	9.22A	11.50A	9.29A
Module Efficiency STC (%)	19.88%		20.10%		20.33%		20.56%		20.78%	
Operating Temperature(°C)	-40°C~+85°C									
Maximum system voltage	1500VDC (IEC)									
Maximum series fuse rating	20A									
Power tolerance	0~+3%									
Temperature coefficients of Pmax	-0.35%/°C									
Temperature coefficients of Voc	-0.29%/°C									
Temperature coefficients of Isc	0.048%/°C									
Nominal operating cell temperature (NOCT)	45±2°C									

* STC: Irradiance 1000W/m² Cell Temperature 25°C AM=1.5

NOCT: Irradiance 800W/m² Ambient Temperature 20°C AM=1.5 Wind Speed 1m/s

* Power measurement tolerance: ± 3%

The company reserves the final right for explanation on any of the information presented hereby. Tiger JKM440-460M-7RL3-V-D2-EN